

User's manual (Canada version)

CD1113

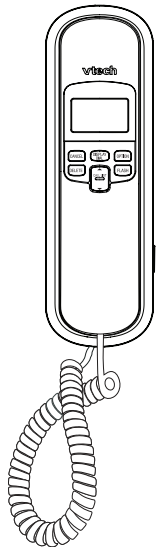

Congratulations

on purchasing your new VTech product. Before using this telephone, please read **Important safety instructions** of this manual.

This manual has all the feature operations and troubleshooting necessary to install and operate your new VTech telephone. Please review this manual thoroughly to ensure proper installation and operation of this innovative and feature rich VTech product. For support, shopping, and everything new at VTech, visit our website at www.vtechcanada.com.

CAUTION: To reduce the risk of fire or injury to persons or damage to the telephone, read and follow these instructions carefully:

- Use only three AA alkaline batteries (not included).
- Dispose of these batteries in a safe manner. Do not burn or puncture. Like other batteries of this type, if burned or punctured, they could release caustic material which could cause injury.
- Do not open or mutilate the battery. Released electrolyte is corrosive and may cause damage to the eyes or skin. It may be toxic if swallowed.
- Exercise care in handling batteries in order not to create a short circuit. Do not allow conductive materials such as rings, bracelets or keys to touch the battery. The battery or conductor may overheat and cause harm.
- Use the battery identified for use with this product only in accordance with the instructions and limitations specified in this manual.
- Observe proper polarity orientation between the battery and metallic contacts.
- Do not disassemble your telephone. There are no user-serviceable parts inside. Refer to qualified service personnel for servicing.

Parts checklist

Your telephone package contains the following items. Save your sales receipt and original packaging in case it is necessary to ship your telephone for warranty service.

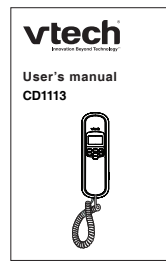

User's manual

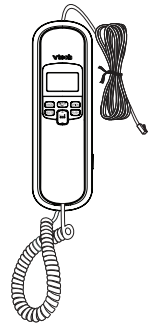

Telephone base and handset with telephone line cord installed

Handset layout

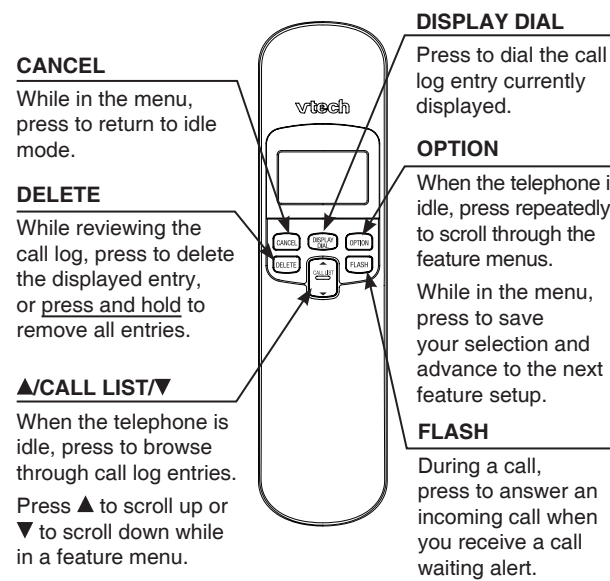

Speed dial keys (M1/M2/M3)

Press to dial the telephone number stored in the corresponding speed dial key.

TOUCH TONE
Press to temporarily switch to tone dialing mode.

MEMORY
Press to enter the memory locations 0-9.

MUTE
Press and hold to mute the microphone. Release to return to the two-way conversation.

VOLUME (LO, MED or HI)
Slide to adjust the listening volume to LO, MED or HI.

Switch hook

When held down, the telephone is in idle mode. When released, the telephone is ready to make a call.

Dialing keys

Press to enter numbers or characters.

REDIAL/PAUSE

Press to redial the last number dialed. When storing a number in the memory, press to add a dialing pause in the dialing sequence.

PROG

Press to store a number in a speed dial location.

Telephone base layout

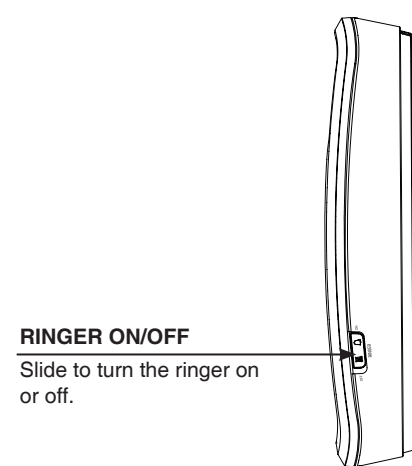

Battery installation

Before using the telephone, install three AA alkaline batteries (not included) to provide memory backup and enable the use of caller ID feature. If batteries are not installed, the display only works when you lift the handset.

If you unplug the telephone from the wall jack, or you lose telephone service for over few minutes, and batteries are not installed, the following information will be lost: call list, numbers stored in the speed dial memory, last number redial and all settings in the feature menu. It is recommended that you initially install new batteries and change the batteries soon after the low battery icon appears.

1. Press the tab and lift upwards to open the battery compartment cover.

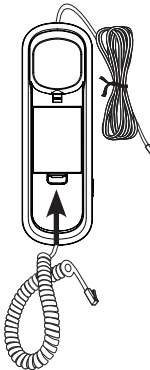

2. Install three AA alkaline batteries (not included) in the battery compartment matching the labels + and - engraved in the battery compartment.

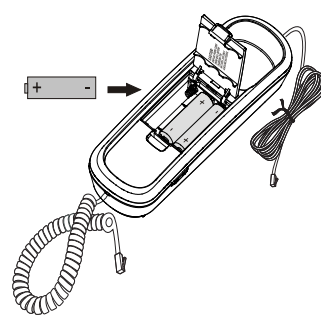

3. Close the battery compartment cover. Make sure it clicks into place.

- note**
- Do not mix old and new batteries. Do not mix alkaline and standard (carbon-zinc) batteries.
 - After you replace the batteries, the clock needs to be reset.
 - If there are no batteries installed and the telephone is plugged into a telephone wall jack, the screen display operates using power from the telephone line when you lift the handset. When operating in this mode, the screen display may be dimmer than usual.

Wall installation

Your telephone base is ready for wall installation. To mount your telephone on a wall, you need a standard dual-stud telephone wall mounting plate. If you do not have this mounting plate, you can purchase one from many hardware or consumer electronic retailers. You may need a professional to install the mounting plate.

If you subscribe to high-speed Internet service digital subscriber line (DSL) through your telephone line, you must install a DSL filter between the telephone line cord and the telephone wall jack. The filter prevents noise and caller ID problems caused by DSL interference. Please contact your DSL service provider for more information about DSL filters.

To mount the telephone on a wall:

1. Route the telephone line cord through the channel as shown below. Then plug the telephone line cord into a telephone wall jack.

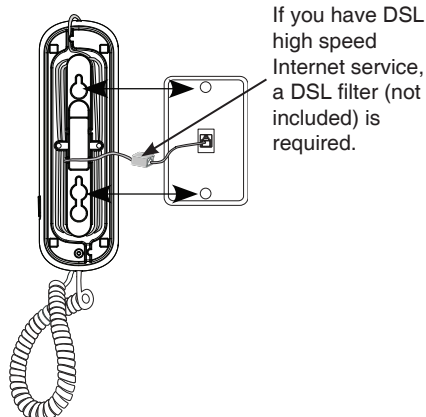

2. Mount the telephone base on the mounting plate. Make sure the mounting holes in the telephone aligns with the mounting studs on the mounting plate. Then push the telephone down until it clicks firmly into place.

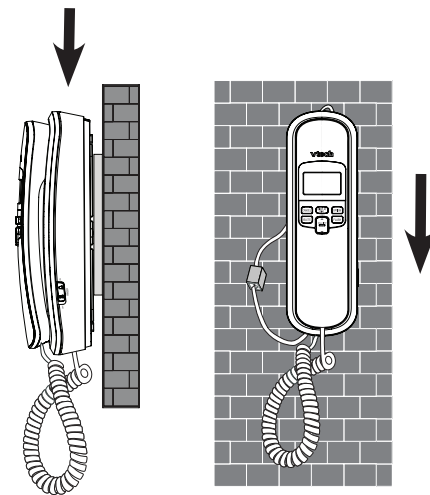

Wall installation to desktop installation

1. Push the telephone up to remove it from the wall plate, then unplug the telephone line cord from the wall jack. Remove the telephone line cord from the channel.

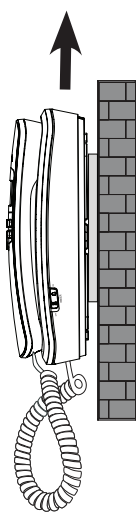

2. Lift the handset and place it aside. On the telephone base, slide the handset tab upwards until it is out of the slot. Rotate the tab 180°, and then insert it back into the slot until it clicks into place.

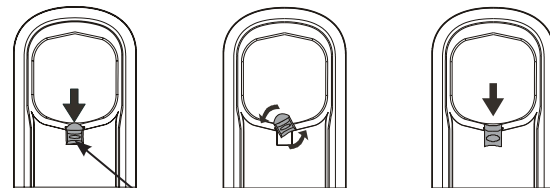

3. Plug the telephone line cord in the telephone wall jack. Bundle it neatly with a twist tie if necessary.

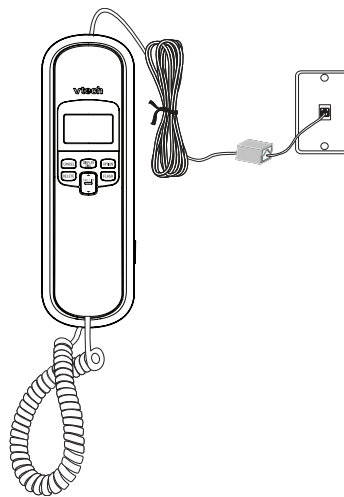

Desktop installation to wall installation

1. Lift the handset and place it aside. On the telephone base, slide the handset tab upwards until it is out of the slot. Rotate the tab 180°, and then insert it back into the slot until it clicks into place.

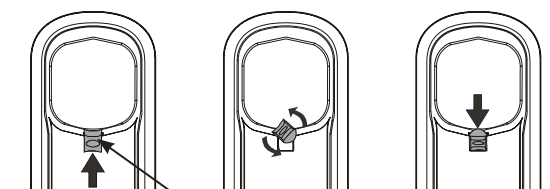

2. Follow the steps in the **Wall installation** section to install the telephone on a wall.

Telephone settings

The telephone screen will display prompts to help you set up the telephone when you first install it. Press **OPTION** to enter, save and browse through the feature menus.

1. Press **OPTION** repeatedly to browse through the feature menus.
 2. Press ▲ or ▼ to scroll through setting options.
 3. Press **OPTION** to save your selection and automatically advance to the next feature setup.
- OR-**
Press **CANCEL** to exit without saving the selection and return to idle mode.

Feature summary

Default settings are indicated by *.

Features	Functions	Options
SET LANGUAGE	Choose a desired language for the screen display.	ENGLISH* FRANCAIS* ESPAÑOL
SET CONTRAST	Adjust the screen brightness to a comfortable level.	1, 2, 3*, 4, 5
HOME AREA CODE?	You must enter a number to make calls from the call log. If you dial seven digits for local calls, enter your area code. If you dial ten digits for local calls, enter three zeros (000) for HAC, and then enter your area code as a local area code (LAC).	HAC-__-__*
LOCAL AREA CODE?	Program up to four local area codes which may not require dialing 1 before them.	LAC1-__-__* LAC2-__-__* LAC3-__-__* LAC4-__-__*
SET TIME/DATE	Set the time and date.	12:00^{AM} 1/01*
SET TONE/PULSE	Choose tone or pulse dialing mode.	TONE* PULSE

Set time and date

If you subscribe to caller ID service, the day, month and time are set automatically with each incoming call. You can also set the time and date manually.

1. Press **OPTION** repeatedly until the screen displays **SET TIME/DATE**.
2. Press ▲ or ▼ to select the appropriate number (1-12) for the hour. Press **DISPLAY DIAL** to move on to set the minute.
3. Press ▲ or ▼ to select the appropriate number (00-59) for the minute. Press **DISPLAY DIAL** to move on to set the month.
4. Press ▲ or ▼ to select the appropriate number (1-12) for the month. Press **DISPLAY DIAL** to move on to set the date.
5. Press ▲ or ▼ to select the appropriate number (1-31) for the date. If you need to make any corrections, press **DISPLAY DIAL** to start from Step 2 again.
6. Press **OPTION** to save and advance to the next feature setup.

Ringer on/off

Slide the **RINGER** switch on the side of the telephone base to turn the ringer on or off. If you turn the ringer off, the telephone will not ring when there is an incoming call. You can still see the caller ID information of the incoming call if you subscribe to caller ID service provided by your telephone service provider.

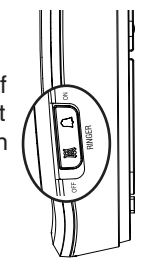

Handset volume

Slide the **VOLUME** switch on the handset to adjust the listening volume. You can set the volume to low (**LO**), middle (**MED**) or high (**HI**).

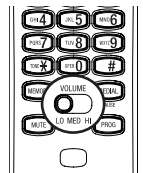

Telephone operation

Make and answer calls

To make a call:

1. Lift the handset and wait for a dial tone.
2. Use the dialing keys to enter the number you want to dial.
3. Place the handset on the telephone base to hang up.

To answer a call:

1. Lift the handset while the phone is ringing.
2. Place the handset on the telephone base to hang up.

Last number redial

The last number dialed is stored in the redial memory (up to 32 digits).

To redial the last number dialed:

1. Lift the handset and wait for a dial tone.
2. Press **REDIAL/PAUSE** on the handset.
3. Place the handset on the telephone base to hang up.

Flash

If you subscribe to call waiting service from your telephone service provider, you hear an alert tone and the screen displays the caller ID information of the new incoming call while you are already on a call. Press **FLASH** on the handset to put your current call on hold and answer the new call. You can press **FLASH** any time to switch back and forth between calls.

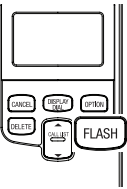

Mute

You can **press and hold MUTE** to mute the microphone. The other party cannot hear you, but you can still hear the other party. Release the button to resume the two-way conversation.



Temporary tone dialing

If you have pulse dial (rotary) service, you can switch to touch-tone dialing during a call. After you hang up or press **FLASH**, the telephone automatically returns to pulse dialing mode.

1. During a call, press **TOUCH TONE**.
2. Use the dialing keys to enter the number. The telephone sends touch-tone signals.
3. The telephone automatically returns to pulse dialing mode a few seconds after you hang up.

Speed dial overview

This telephone can store up to 13 telephone numbers in the speed dial locations (**MEMORY 0 - MEMORY 9, M1, M2 and M3**) for fast dialing. Each location can store a number that is up to 32 digits.

Store a speed dial entry

1. Lift the handset and press **PROG**.
 2. Use the dialing keys to enter the number you want to store. Press **REDIAL/PAUSE** once to store a 3-second pause in the dialing sequence, twice for a 6-second pause and so on.
 3. Press **MEMORY**, then press a dialing key (**0-9**) to save the entry.
- OR-**
Press **M1, M2** or **M3** to save the entry.

note You cannot delete a speed dial entry. To replace the entry in the speed dial location, you need to store a new speed dial entry.

Review a speed dial entry

1. Lift the handset and hold down the switch hook on the handset.
 2. Press **MEMORY**, then press the corresponding speed dial location (**0-9**) to display the desired entry.
- OR-**
Press **M1, M2** or **M3** to display the desired entry.

Dial a speed dial entry

1. Lift the handset and wait for a dial tone.
 2. Press **MEMORY**, then press a dialing key (**0-9**) to dial the desired entry.
- OR-**
Press **M1, M2** or **M3** to dial the desired entry.

